



colin ellis

## Dale Close, Burniston, Scarborough, YO13 0ED

Located in a cul-de-sac within the highly sought after village of Burniston, this two bedroom semi-detached home offers fantastic potential. While the property is in need of refurbishment throughout, it presents an excellent opportunity for a buyer to modernise and create a lovely home to their own taste.

The ground floor comprises, a good-sized living room with feature fireplace, and a kitchen/diner overlooking the rear garden. To the first floor are two bedrooms and a family bathroom.

Outside, the property benefits from a private rear garden, driveway parking, and a garage providing additional storage.

Situated just a short distance from local amenities, schools, and transport links, the home combines village living with convenient access to Scarborough and the surrounding area.

Offered with no onward chain.

Offers In The Region Of £180,000



2



1



1



E



## LIVING ROOM

3.64 x 4.41 (11'11" x 14'5")

## KITCHEN

2.66 x 4.45 (8'8" x 14'7")

## BEDROOM

2.68 x 4.41 (8'9" x 14'5")

## BEDROOM

3.64 x 2.68 (11'11" x 8'9")

## BATHROOM

2.69 x 1.63 (8'9" x 5'4")









Floor 1

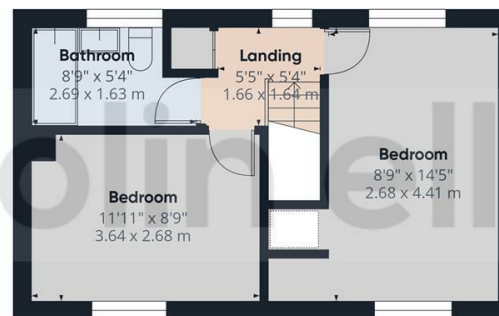

Floor 2



Approximate total area<sup>(1)</sup>

664 ft<sup>2</sup>  
61.7 m<sup>2</sup>

(1) Excluding balconies and terraces

Calculations reference the RICS IPMS 3C standard. Measurements are approximate and not to scale. This floor plan is intended for illustration only.

GIRAFFE360

**Dale Close, Burniston - 18746869**

**Council Tax Band - C**

**Tenure - Freehold**

DISCLAIMER: The agent has not tested any apparatus, fittings or services and so cannot verify they are in working order. The buyer is advised to obtain verification from their own solicitor or surveyor. Occasionally a wide angle lens may be used. This property was inspected by COLIN ELLIS PROPERTY SERVICES. We always try to make our sales particulars accurate and reliable, but if there is any point which is of particular importance to you, especially if you are considering travelling some distance to view the property, please do not hesitate to contact this office, we will be pleased to check the information for you. Council Tax Band ratings have been provided by DirectGov.

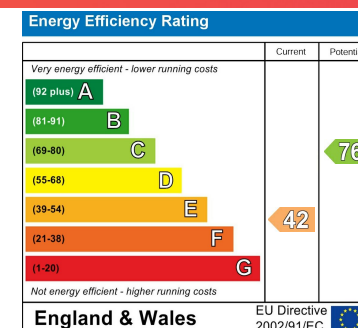

**Tel: 01723 363565**

**E-mail: [info@colinellis.co.uk](mailto:info@colinellis.co.uk)**

**RESIDENTIAL & COMMERCIAL SALES  
LETTINGS CHARTERED SURVEYOR**

**See all our properties online  
[www.colinellis.co.uk](http://www.colinellis.co.uk)**